

Canvas
Chrome

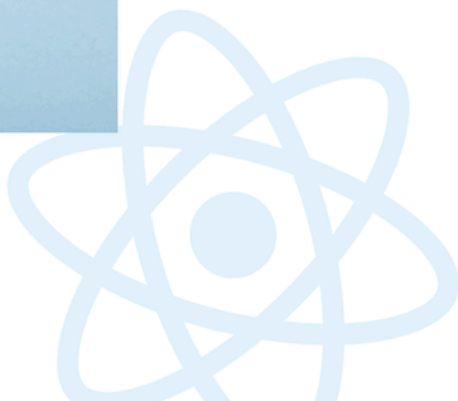

DESIGN PORTFOLIO

A Graphic Design Solution for all

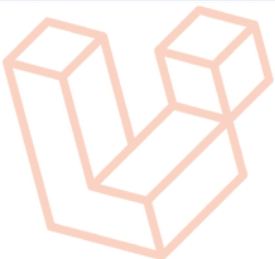

About Us

Welcome to Canvas Chrome Design, where creativity meets precision! We are a passionate team of graphic designers dedicated to bringing your ideas to life through stunning visual solutions.

Our Mission

Our mission is to elevate your brand and messaging through innovative graphic design. We believe that every project is an opportunity to create something exceptional, something that not only captures attention but leaves a lasting impression.

Our Approach

With a blend of artistic flair and technical expertise, we approach every project with meticulous attention to detail. Whether it's crafting a compelling logo, designing engaging marketing collateral, or developing a user-friendly website, we aim for excellence in every pixel.

Take a look at our portfolio to see the diverse range of projects we've worked on. Each piece showcases our dedication to delivering exceptional design solutions.

Creative Team
Canvas Chrome Designs



TABLE OF CONTENT

4

HOME DECOR

6

HOTEL RESTAURANTS

8

REALESTATE

10

INFOTECH

12

INTERIOR ARCHITECT

14

HEALTHCARE

16

LOGO DESIGN

22

SERVICES

24

MOBILE APP

25

REFERENCE LINK



01	HOME DECOR
----	------------

CLIENT :
KANHAIYA TRADING COMPANY

Canvas Chrome Design had the privilege of collaborating with Kanhaiya Trading Company, a distinguished furniture manufacturer specializing in exquisite interior and home decor solutions. Based in the vibrant city of Lucknow, Kanhaiya Trading Company prides itself on crafting timeless pieces that seamlessly blend tradition with modern aesthetics.

A Vector Representation of Lord Krishna in a Circular Frame, The logo represents divinity, creativity, and a touch of cultural heritage, reflecting the essence of Kanhaiya Trading Company's craftsmanship.



5





02	Hotel Restaurant
----	------------------

Kitchen Art

A. comprehensive branding project for "Kitchen Art," a distinguished food company specializing in hotel services. With a keen understanding of their culinary expertise, we crafted a visual identity that captures the essence of their culinary mastery. The logo, a fusion of modernity and gastronomy, features clean lines and vibrant hues that symbolize innovation and freshness. The catalog design showcases their diverse culinary offerings with mouthwatering visuals and elegant layouts, ensuring a memorable impression on prospective clients.



03	REALESTATE
----	------------

CLIENT :
1INFRA

Welcome to our 1 INFRA, your ultimate destination for all things related to buying, selling, and renting properties. Whether you're a first-time homebuyer or a seasoned investor, we are here to assist you in finding the perfect property to meet your unique needs. With years of experience in the field, they have a deep understanding of the market trends and can provide valuable insights and guidance to clients.



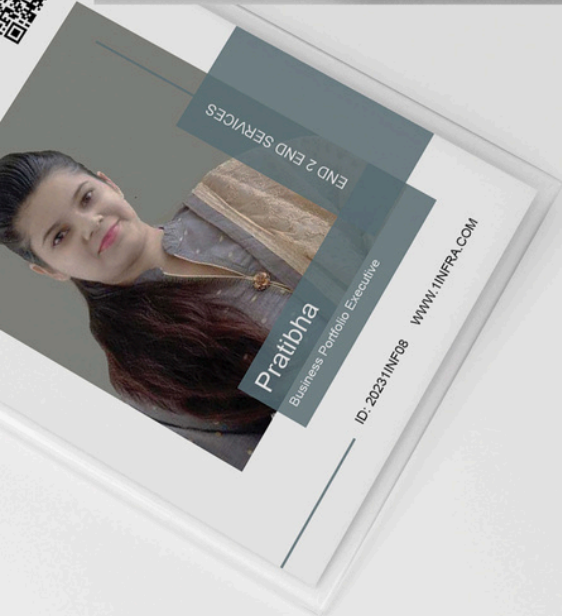

Canvas Chrome Design is thrilled to showcase our extensive branding collaboration with "1Infra," a leading player in the real estate industry. With a vision for innovation and excellence, we embarked on a journey to establish a visual identity that embodies their commitment to quality and modernity. The cornerstone of this project was the creation of a distinctive logo that seamlessly integrates architectural elements, reflecting the company's core values of precision and craftsmanship. Our team extended this design language to craft an array of collateral, including a sleek and professional invoice template, a captivating brochure highlighting their premier properties, and a cohesive stationary set exuding professionalism in every detail. Additionally, we curated a dynamic social media presence, aligning with their forward-thinking approach and engaging their audience with compelling visuals and content. This comprehensive branding solution for "1Infra" represents our dedication to not only meeting but exceeding the unique needs of our clients in the real estate sector. We are immensely proud to have partnered with "1Infra" and look forward to witnessing their continued success in shaping the landscapes of tomorrow.

ABOUT US

Crafting digital solutions with innovation.

We are driven by a passion for technology and a commitment to empowering our clients through digital innovation. Established with a vision to be the catalyst for our clients' digital transformation, we have consistently delivered cutting-edge solutions that drive business growth and enhance operational efficiency.

"To witness the awe of the excellence brigade, get in touch with us"

"Be Seen. Get Viral. Grow Your Brand"

Spread like wildfire by empowering your audience, and providing them with one-of-a-kind, real experience."

Our mission is to assist brands in creating contagious content on social media, by motivating their following, involving their users, and delivering distinct, genuine experience

SOCIAL MEDIA

Our digital specialists can create campaigns to capture your audience. We analyze competitor and customer behavior, to develop strategies tailored to your brand.

OUR SERVICES

Creating a masterpiece of artistry, function, and profitability through harmonious integration of aesthetics, digital tools, and innovative ideas

SEM

Let us create a strategy that can create a competitive advantage for you.

PPC MANAGEMENT

Maximized ROI with our data-driven PPC Certified expert craft targeted ads, optimize bidding and targeting, and monitor performance. Leverage seasonal trends for high-volume leads and traffic to promote products with precision.

EMAIL MARKETING

Unlock the power of email marketing without agency cost effective and efficient, it's the key to helping you promote your brand and make sales. Let us help you make the most of it!

UPCLOUD GLOBAL SOLUTIONS
ELEVATING YOUR DIGITAL HORIZANS!

www.upcloudglobal.com

SERVICES/SOLUTIONS

SERVICES

- ✔ WEBSITE DESIGNING
- ✔ WEBSITE DEVELOPMENT
- ✔ DOMAIN REGISTRATION
- ✔ WEB HOSTING SERVICE
- ✔ BULK SMS MARKETING
- ✔ PROMOTIONAL SMS
- ✔ OTP SMS
- ✔ ATTACHMENT SMS
- ✔ REGIONAL SMS

SOLUTIONS

- ✔ RICH MEDIA SMS
- ✔ BULK EMAIL MARKETING
- ✔ LEAD GENERATION [EMAIL/SMS]
- ✔ VOICE CALLS/OBD
- ✔ SHORT CODE
- ✔ LONG CODE
- ✔ IVR SERVICE/VIRTUAL NUMBER
- ✔ MISSED CALL ALERT SERVICE
- ✔ WHATSAPP PROMOTION
- ✔ SMPP PROVIDER

SOLUTIONS

- ✔ BULK SMS
- ✔ SOFTWARE
- ✔ CRM/CMSS
- ✔ BULK EMAIL
- ✔ BULK EMAIL
- ✔ WEB APPLI
- ✔ ECOMMER
- ✔ IOS/ANDR
- ✔ GRAPHIC
- ✔ ALL CUSTO

PACKAGES

	BASIC	STANDARD	PRO
Facebook & Instagram	✔	✔	✔
LinkedIn / Pinterests / Twitter	X	Any One	Any Two
Identifying Goal	✔	✔	✔
Account Management	✔	✔	✔
Analyzing audience	✔	✔	✔
Social Media Calender	✔	✔	✔
Content Marketing	✔	✔	✔
Hashtag Management	✔	✔	✔
Social Trending	✔	✔	✔
	₹ 25000	₹ 35000	₹ 50000

10% /per ad budget

- Ad account & ad manager setup
- Ad campaign management
- Ad Creative banner
- Boost post to increase engagement
- Bid strategy
- Budget management
- Comment management
- Keyword Analysis
- Target Market research
- Campaign structure optimisation

Empowering Your Online Presence

04
INFOTECH

CLIENT :
UPCLOUD GLOBAL SOLUTIONS

UpCloud Global Solutions, a distinguished IT company, on a diverse spectrum of design projects, exemplifying our unwavering dedication to visual excellence. Our scope of work encompassed strategic social media post design and management, a rigorous logo redesign, the creation of compelling brochures and flyers, and the refinement of critical documents. These endeavors collectively bolstered UpCloud Global Solutions' online presence and established a unified, polished brand image. Our collaboration extended well beyond these pivotal initiatives, with Canvas Chrome consistently delivering influential design solutions that elevated UpCloud Global Solutions' visual identity and messaging to the highest professional standards.



05	INTERIOR & ARCHITECT
----	----------------------

CLIENT :
S2F Creations

Canvas Chrome Designs had the privilege of collaborating with S2F Creations, a distinguished player in the realm of interior design and architecture. Our partnership encompassed a comprehensive branding endeavor, which began with the creation of a distinctive logo. This emblem encapsulates the essence of S2F Creations - a fusion of artistry and precision in the world of interior and architectural design. The journey continued with the development of a dynamic website, meticulously designed to showcase their portfolio with elegance and user-friendly navigation. Our team also crafted a striking visiting card design, reflecting the company's ethos of making impactful first impressions in the world of interior and architectural aesthetics. To complete the branding experience, an engaging introductory video was produced, offering viewers a captivating glimpse into the world of S2F Creations. This project stands as a testament to our commitment to translating our clients' visions into compelling visual narratives. We are honored to have partnered with S2F Creations and are excited to witness their continued success in shaping spaces with creativity and architectural excellence.



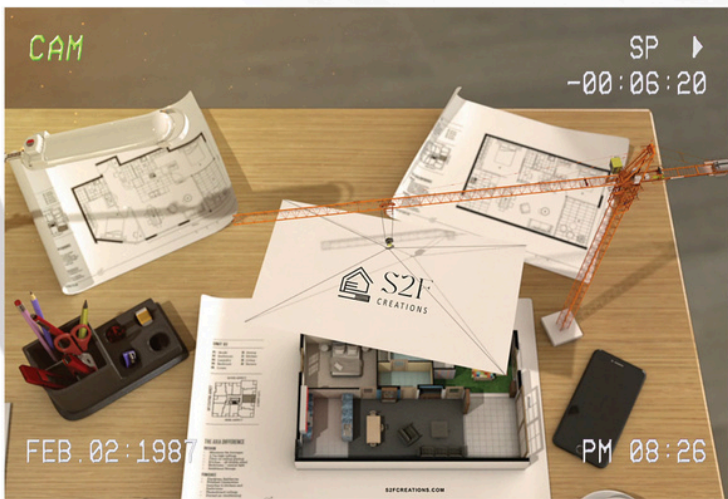



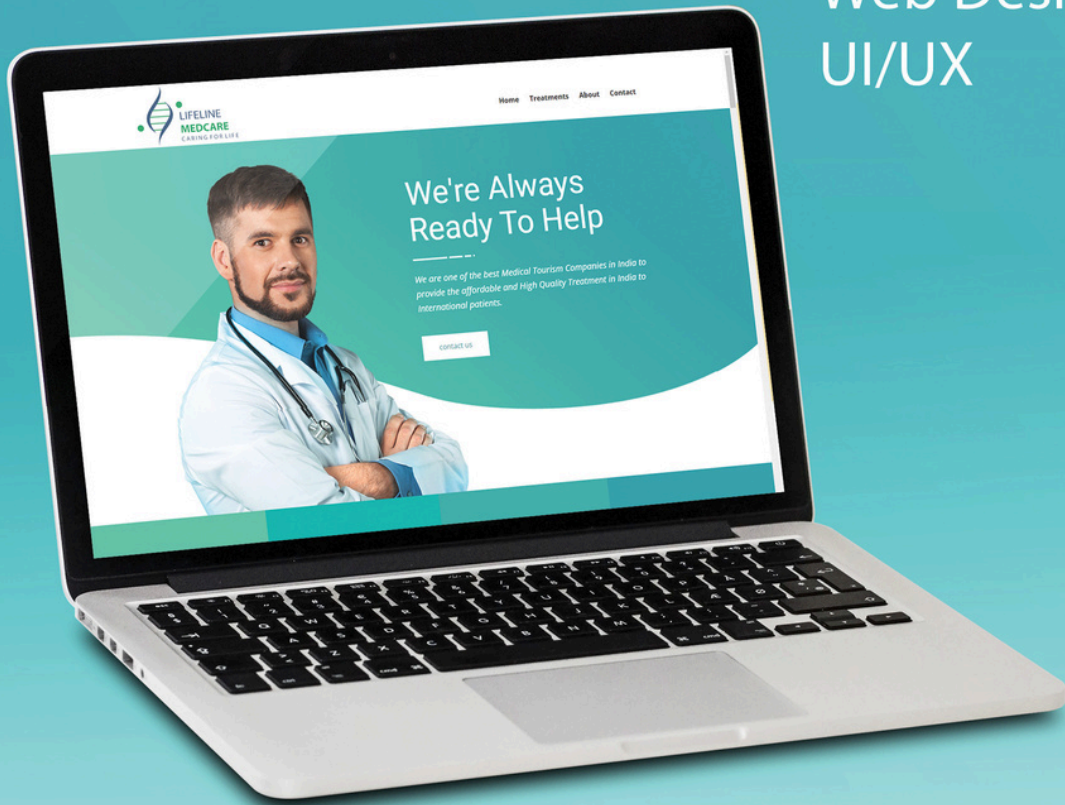

06	HEALTHCARE
----	------------

CLIENT :
Lifeline Medicare

Canvas Chrome had the privilege of partnering with Lifeline Medicare, undertaking a comprehensive array of design projects that underscore our dedication to visual excellence. Our scope of work encompassed social media post design and management, a meticulous logo redesign, the creation of compelling brochures and flyers, as well as the refinement of various essential documents. These efforts collectively contributed to Lifeline Medicare's robust online presence and a cohesive, professional brand image. Our collaboration extended beyond these key endeavors, with Canvas Chrome consistently delivering impactful design solutions that elevated Lifeline Medicare's visual identity and messaging.



LIFELINE
MEDCARE
CARING FOR LIFE

LOGO DESIGN

The logo for Lipi Creations features a stylized 'L' on the left, composed of a vertical bar with a horizontal bar at the top and a vertical bar at the bottom, all in a grey color. To the right of this 'L' are the letters 'I', 'P', 'I', and 'I' in a bold, sans-serif font, also in grey.

Lipi Creations

The logo for OCEENN features a circular icon on the left, which is a grey ring with a white circle inside. To the right of the icon is the word 'OCEENN' in a bold, sans-serif font, with the 'E's having a unique shape. Below 'OCEENN' is the text 'DESIGN & EXHIBIT' in a smaller, sans-serif font.

*Ocean Design
& Exhibit*

The logo for Lifeline Medicare features a stylized DNA double helix on the left, with a blue outer curve and green horizontal bars. To the right of the DNA is a green dot, followed by the text 'LIFELINE' in blue, 'MEDCARE' in green, and 'CARING FOR LIFE' in blue below it.

*Lifeline Medicare
Care*



Ieducationlize



RB Studios



Rajendra Food Product

LOGO DESIGN

Bowl Buddies



Smash N Grill



Rolling Wraps





Mezbaan Biryani



Salt Affair



*The Sugar Rush
Fairy*

LOGO DESIGN



KANHAIYA
TRADING COMPANY

Kanhaiya Trading



iNFRA
END2END SERVICES

1Infra



A Square Decor



Kitchen Art



VEHISCOPE

CRAFTING SERVICES, INSPIRING TRUST

Vehiscope



UPCLOUD GLOBAL

SOLUTIONS

ELEVATING YOUR DIGITAL HORIZANS!

Upcloud Global Solutions

SERVICES

Logo Design
Business Card Design
Stationary Design
Label Design
Letter Head Design
Signage Design
Billboard design
Trade Show Booth
Car Wrap Design
Invoice Design
3D Logo Design
ID Card Design
Banner Design
Web Banner Design
Social Media Design
Youtube Banner &
Thumbnail
Facebook Cover &
Post Design
Insta Post Design
LinkedIn Cover Design
Flyers and Posters
Catalogs and Portfolio
3D Mockups
Magazine
Book Cover Design

Logo Animation
2D Animation
Presentation Video
Commercial Videos
Product design
Promotional Videos
2D and 3D animation



Web Design
App Design
UI/UX
Figma App Design
Desktop App (UI/UX)
Landing Page
Website Development

Ecommerce Website
Ecommerce App
Wordpress
Email Design
React js

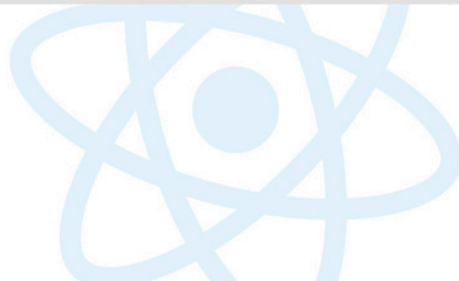
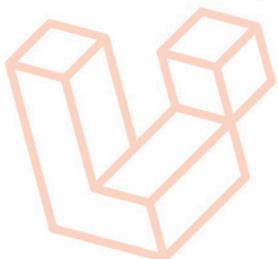

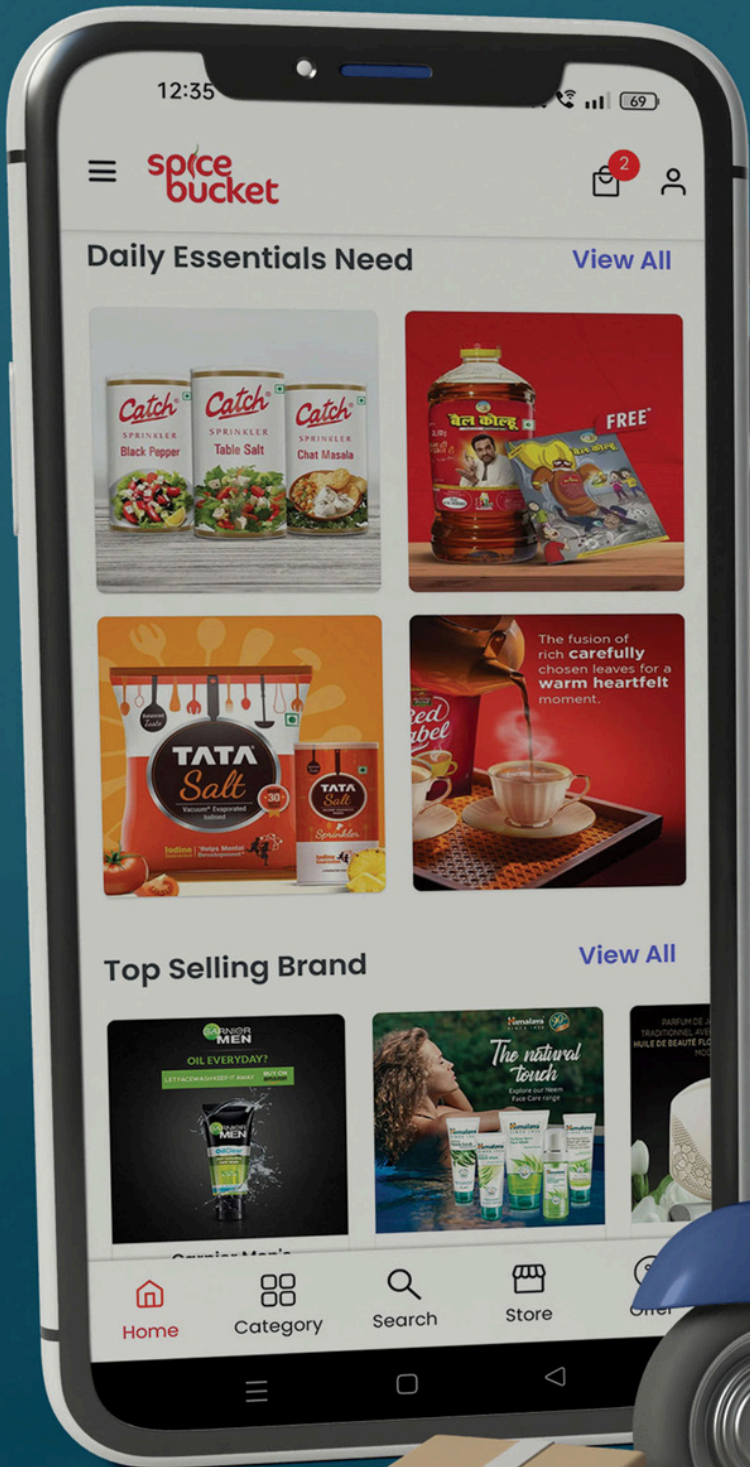

Reference Links

Website Links

<https://lenoredesign.in/>
<https://s2fcreations.com/>
<https://lifelinemedcare.com/>
<https://upcloudglobal.com/>
<https://1infra.com/>
<http://ieducationalize.com/>
<https://www.simplekindness.co/>
<https://www.vehiscope.in/Default>
<https://www.spicebucket.com/>
<https://www.nurturebynaps.com/>
<https://space.io/>
<https://www.zicaindore.com/>
<https://voteonchain.com/>
<https://ethoventures.com/>
<https://d341wus106lofa.cloudfront.net/>
<https://www.wallstmemes.com/>
<https://www.coinnews.com/>
<https://www.wsmcasino.com/>
<https://paladinobuilt.com/>
<https://bigskypackaging.com/>
<https://educationoracle.vercel.app/>
<https://durianfurniture.in/veneer-door-bengaluru/>
<https://doozie-do.com/>
<https://www.toyniquetoys.com/>
<https://sgvu.vidyaplanet.co.in/>
<https://ecollegevidya.com/>
<https://www.onlinelpu.co.in/>
<https://www.gyaneager.com/>
<https://greenwoodzschool.com/>
<https://www.blendedlearningschool.com/>
<https://wilp.sikkimalpineuniversity.edu.in/>
<https://www.birtikendrajituniversity.ac.in/>
<https://buddhaworldschool.com/>
<https://gitprime.in/>

Application Link

<https://play.google.com/store/apps/details?id=com.spicebucket>

Google My Business

<https://maps.app.goo.gl/4dsUvZQebP3tuTvA8>

Social Media Links

<https://www.instagram.com/s2fcreations/>
<https://www.facebook.com/S2FCreations>
<https://www.linkedin.com/company/s2fcreations/>
<https://www.facebook.com/LMedcare/>
https://www.instagram.com/lifeline_medcare/
<https://www.instagram.com/vehiscope>
<https://www.linkedin.com/company/zoe-carpet/posts/?feedView=all>
<https://www.linkedin.com/in/kristin-schmidt-larson-capm-mba-88b0aa3a/>
<https://www.linkedin.com/in/dr-usha-rajagopalan-89291947/>
<https://www.linkedin.com/company/oyf-staffing/posts/?feedView=all>
<https://www.linkedin.com/company/simple-kindness-llc/posts/?feedView=all>



Nothing can ever designed without creativity and creativity needs time to build a new world of design either its motion or graphic or animation.

www.canvaschrome.com

